

---

## HOWARD DEBECK ELEMENTARY SCHOOL SEISMIC UPGRADE

---

|                                   |  |
|-----------------------------------|--|
| <b>TARGET CONSTRUCTION START:</b> | November 2023  |
| <b>TARGET COMPLETION:</b>         | August 2025  |
| <b>PROJECT BUDGET:</b>            | \$20.74 Million  |
| <b>FUNDING SOURCES:</b>           | Ministry of Education Capital Plan - \$20.74 Million (maximum) |
| <b>CONSULTANT:</b>                | Thinkspace Architecture Planning Interior Design Ltd.          |
| <b>CONSTRUCTION MANAGER:</b>      | Unitech Construction Management Ltd.                           |
| <b>PROJECT MANAGER:</b>           | Richmond Project Team  |
|                                   | Enquiries: Jose Pelayo, 604-295-7000 ext. 7800                 |

### BACKGROUND

Howard DeBeck Elementary is in a single-storey wood frame building of 3,332 m<sup>2</sup>, constructed in 1991 with additions and renovations in 2000. School District No. 38 (Richmond) has confirmed that the school is needed for the long term as part of the overall long-range strategic planning.

The K-7 school, which consists of three distinct blocks, was seismically assessed using Version 3 of EGBC's Seismic Retrofit Guidelines. The entire school has a moderate-high risk of liquefaction potential requiring substructure upgrades, with Block 1 (1991 Original Classrooms/Library) having a Seismic Risk Category H1 rating, Block 2 (1991 Gymnasium/Administration) having a Seismic Risk Category H2 rating and Block 3 (2000 Classrooms Addition) having a Low Risk rating.

### PROJECT SCOPE

- Seismic retrofit to achieve a life-safety level includes reinforcing existing brace bay columns with cross-bracing and column enhancements, adding new braces, thickening and widening existing brace bay footings, re-pinning the existing roof deck and adding new steel strapping and steel angle to its underside, and upgrading connections throughout.
- Non-structural seismic resistance upgrade to the entire school (added restraint of lighting, HVAC, plumbing and cabinets).
- Restoration of wall/floor/ceiling/exterior finishes and hard/soft landscaping affected by the structural work, addition and demolition.
- Minor removal and replacement of mechanical and electrical equipment to accommodate structural work.

### PROJECT STATUS

- Project approval and funding agreement received from the Ministry of Education and Child Care 22 February 2023
- Prime Consultant and Construction Manager selected with contracts being procured
- Expect design start-up 01 March 2023

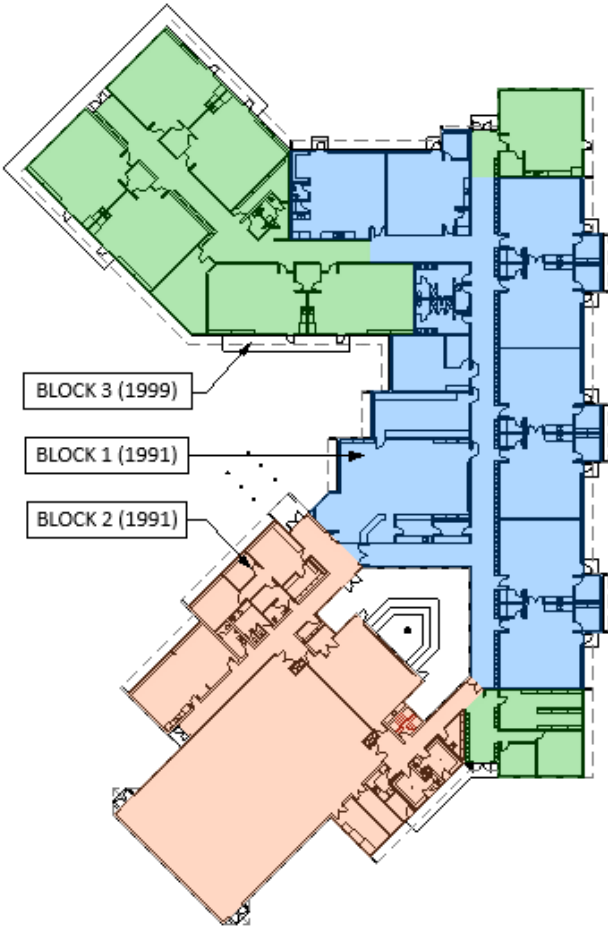

Seismic Block Map – Howard DeBeck Elementary